

1A Active Balance Module Instruction

Dongguan Balanced Management Technology Co., Ltd

Wire Diagram

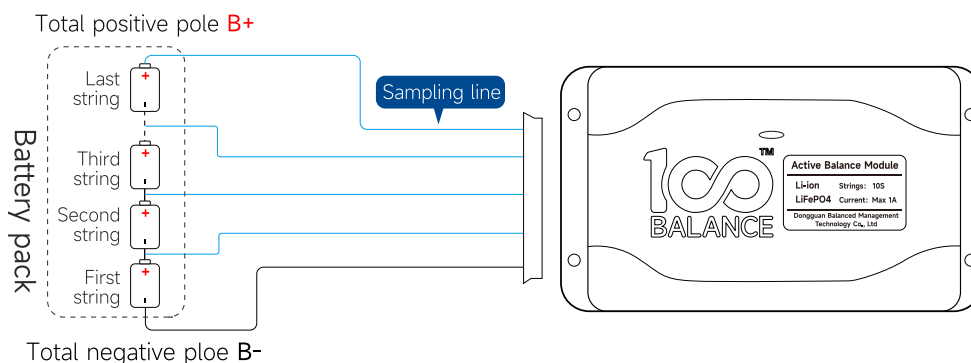

※**Notice:** the sampling cables of different manufacturers are not universal, please make sure to use the right cables; Active balance module strings must match the same number of strings of battery.(eg: 4S active balance module only use for 4S battery pack).

Active Balancer Connection Steps

Attention! ! ! When soldering the sampling cable, do not insert the cable into the active balance module.

1.Solder the cable.

The cable is connected from the thin black wire to the total negative B-, the second wire (the first blue wire) is connected to the positive electrode of the first string of batteries, and the positive electrode of each string of batteries is connected in turn, until the last blue wire is connected to the total battery. Positive B+.

2.Voltage measuring.

After the cable is connected, do not plug into the active balance module directly, Pls measure the voltage between every two adjacent metal terminals on the back of the plug. Make sure to collect the correct voltage for each string before proceeding to the next step.

Note:If it is NMC battery, the voltage should be between 3.0~4.15V; the LFP battery should be between 2.5~3.6V.When minimum single string voltage is below 1V,that battery pack were not allowing to be connected to the active balance module.

3.Plug the sampling cable in.

Insert the plug of the sampling cable into the connector of the active balance module.

4.Balance on condition:First single string voltage $\geq 3.1\pm 0.1V$.

5.Balance closing condition:First single string voltage $\leq 3.0\pm 0.1V$.

6.Description of the status light of the active balancer : green light on - balancing on; green light off - balancing off.

7.Finally, if you have any other questions, please contact customer service or sales staff to help you to solve it.

Dongguan Balanced Management Technology Co.,Ltd

WHATSAPP: 18938279050

E-mail: jhbbms@100balancebms.com

ADDRESS:

20th Floor, Building 7, No. 14 Industrial South Road, Songshan Lake Park, Dongguan City, Guangdong Province